

Enterprise Unit 20/20 Rule = NO

CRC

- Must be at least 50 acres planted in at least 2 different sections
- 2 or more basic units ~ 2 or more optional units

RA

- Must be planted in at least 2 different sections
- 1 or more basic units ~ 2 or more optional units

At least two of the sections must each have planted acreage that constitutes at least the lesser of 20 acres or 20% of the acres in the enterprise unit

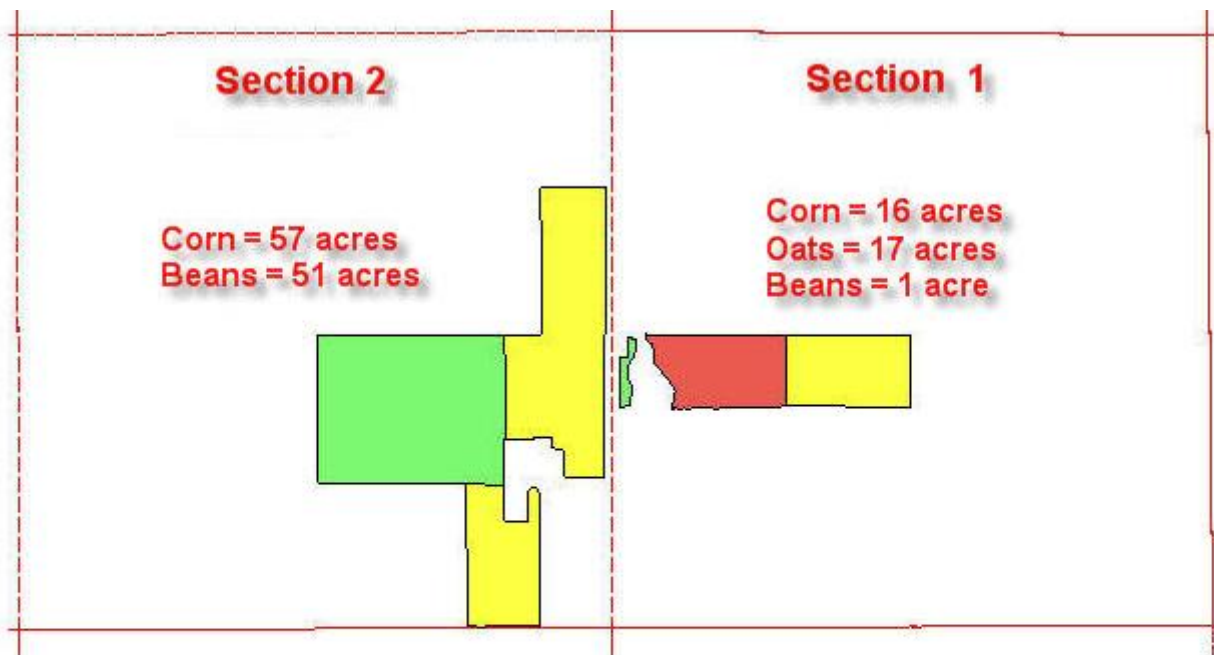

Total Corn = 73 acres, 20% = 14.6 acres. Meets the 20/20 rule!
Total Beans = 52 acres, 20% = 10.4 acres. 20/20 rule not met!

Corn would qualify for an Enterprise Unit Discount.

BUT

Soybeans would not qualify for an Enterprise Unit Discount!



Enterprise Unit 20/20 Rule = YES

CRC

- Must be at least 50 acres planted in at least 2 different sections
- 2 or more basic units ~ 2 or more optional units

RA

- Must be planted in at least 2 different sections
- 1 or more basic units ~ 2 or more optional units

At least two of the sections must each have planted acreage that constitutes at least the lesser of 20 acres or 20% of the acres in the enterprise unit

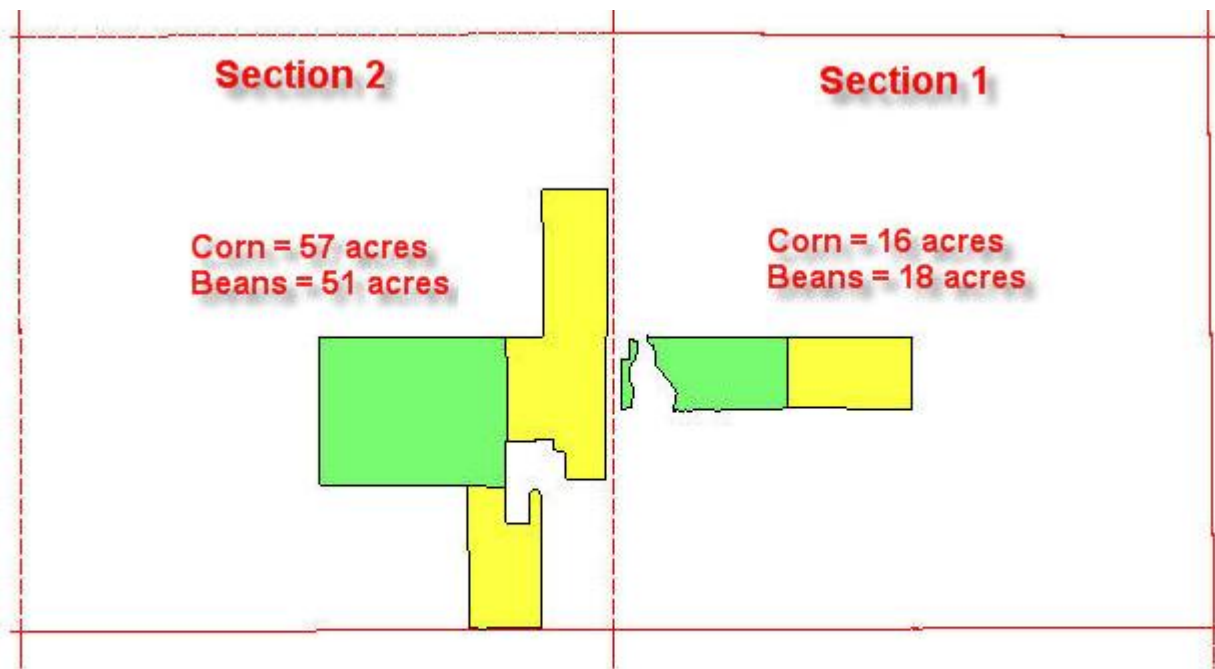

**Total Corn = 73 acres, 20% = 14.6 acres. Meets the 20/20 rule!
Total Beans = 69 acres, 20% = 13.8 acres. Meets the 20/20 rule!**

**Corn would qualify for an Enterprise Unit Discount.
AND
Soybeans would qualify for an Enterprise Unit Discount!**

